

M/S MATINA





The impressive beam of **M/S MATINA** combined with her sail area of 1,500 m² ensures a fascinating but stable and smooth sailing performance.

Her broad teak-deck provides ample space for sunbathing or relaxing on the large cushions.



INTERIOR



The comfortable interior spaces built from mahogany wood and neutral color fabrics offer a cozy and a relaxing atmosphere. The main saloon where a group of twenty guests may dine in style around a cherrywood dining table. The main saloon leads to the broad aft deck with dining facilities for all the guests.

ACCOMMODATION

The accommodation on **M/S MATINA** is very comfortable; the eight luxury cabins are exquisitely finished throughout with a rubbed effect mahogany wood. Each cabin is fully air-conditioned, has private en suite facilities, a radio/CD player, a safe deposit box and ample storage space.



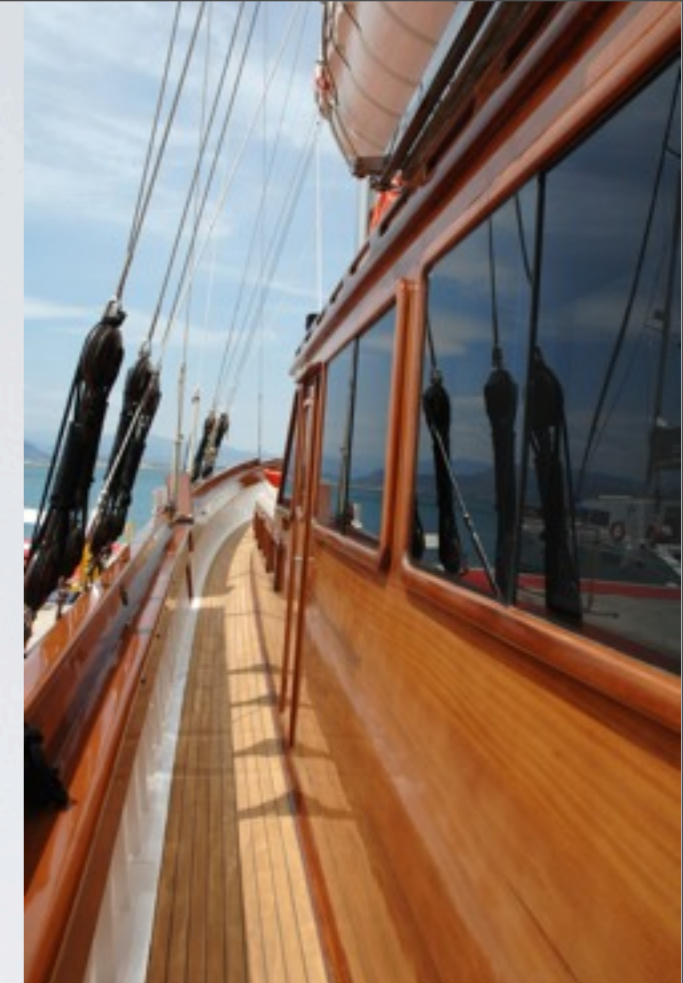

M/S MATINA



SPECIFICATION



Length: 124' 8" (38 m)

Beam: 30' 10" (9,40 m)

Draft: 12' 2" (3,70 m)

Built: 2000

**Engines & Generators: Caterpillar
542HP**

1x John Deere 33KWA

1x Onnan 22KWA

Gross Tons: 250

Cruising Speed: 10 knots

Fuel Consumption: 140 lt/hr

Number of Cabins: 8

**Number of Guests: 20 (sleeping)
49 (cruising)**

Crew: Captain + 5

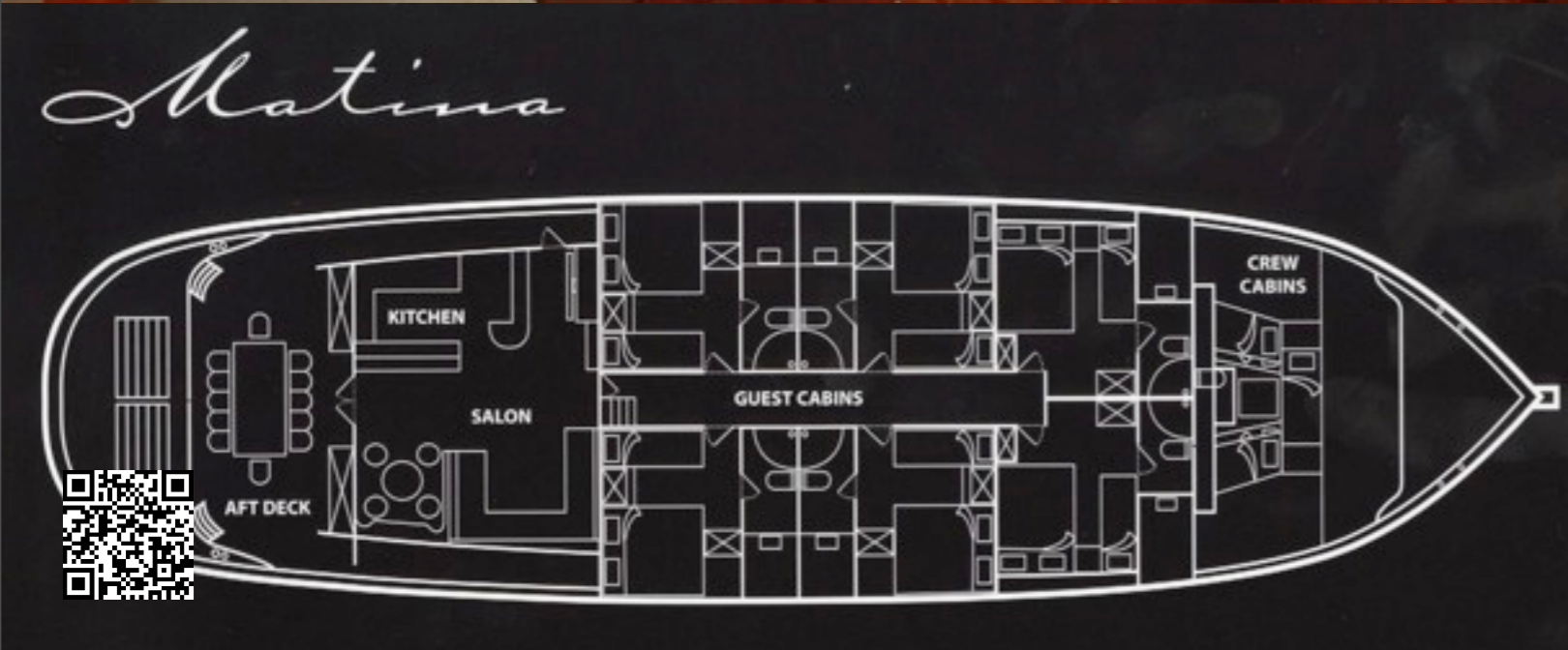

WATER TOYS

Tender with 50HP (4,30 m) with an
outboard engine

Waverunner

Wind surf

Water Ski

Couch

2 kayaks

Paddle board

Wakeboard

Banana - Tubes

Fishing & Snorkeling gear



OCEAN YACHTING

