



MOTOR SAILOR

ATALANTE

24.0 m (78'7") / 2009 / 4 Cabins / 8 Guests

 OCEAN YACHTING



ATALANTE



















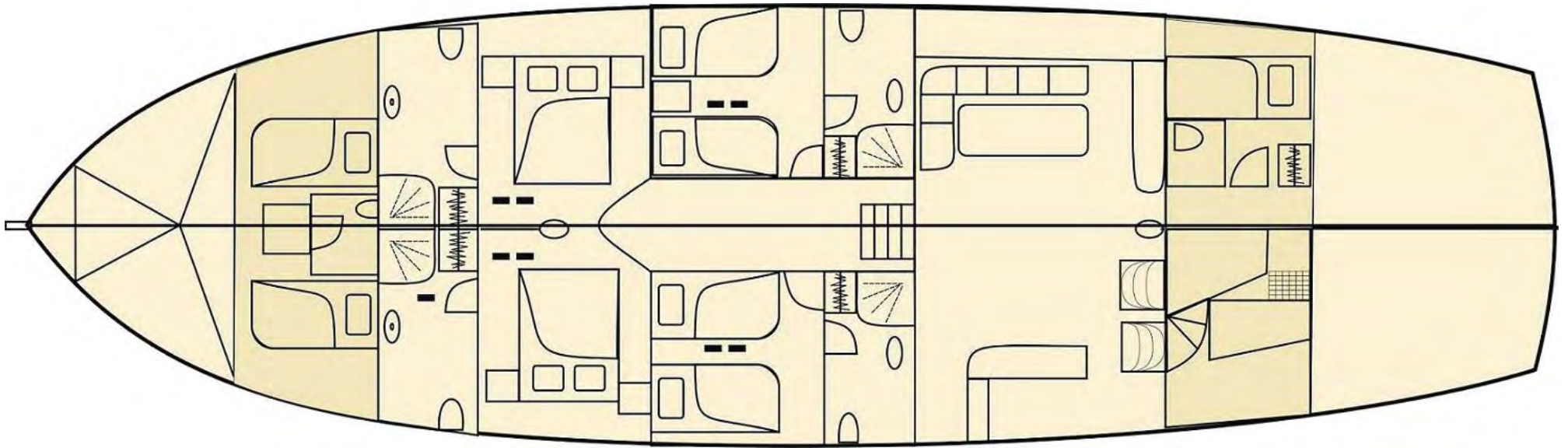

MOTOR SAILOR

ATALANTE

SPECIFICATIONS

Type	: Motor Sailor / Gulet
Flag / Registry	: Turkish Commercial
Base Port	: Bodrum
Length	: 24.0 m / 78'7"
Beam	: 6.5 m / 21'3"
Built / Refit	: 2009
Crew	: 4
Builder	: Bodrum Shipyard
Cruising Speed	: 11 Knots
Construction	: Wood
Masts & Rig	: 2 / Gulet
Engines	: Fiat Iveco 2 * 280 hp
Electricity	: 220 V / 24 V
Generators	: Onan 2 * 17,5 kVA

ACCOMMODATION DETAILS

Cabins	: 2 Double & 2 Twin Cabins Convertible to Doubles
Bathrooms	: En-suite, Shower Cells
Air Conditioning	: Full
Salon	: Dining & Seating Area, Bar
Crew Quarters	: Separate
Galley	: Fully Equipped

NUMBER OF CABINS

4

NUMBER OF GUEST

8

LENGTH OVER ALL

24.0 m

ENTERTAINMENT & TOYS

TV, DVD in Salon, TV and Hair Dryers in All Cabins, Satellite Cinema TV, Music System in Salon, Deck Speakers, Games, 4.20 m Joker with 60 hp Outboard, 2 * Canoe, Water-ski (optional), Wakeboard (optional), Snorkeling Equipment, Basic Fishing Equipment

NAVIGATION & SAFETY

Radar, GPS, VHF, Autopilot, Deep Sounder, AIS, Liferaft, Lifejackets, Fire Extinguishers

All specifications are given in good faith to the best of knowledge and offered for informational purposes only. The owner(s) and broker(s) do not warrant or assume any legal liability or responsibility for the accuracy, completeness, or usefulness of any information and/or images displayed. Yacht inventory, specifications and charter prices are subject to change without prior notice. None of the text and/or images used in this brochure maybe reproduced without written consent from the owner(s) and broker(s).