



MOTOR SAILOR

# CANER IV

36.0 m (118') / 2008 / 6 Cabins / 12 Guests

 OCEAN YACHTING





CANER IV



 OCEAN YACHTING







































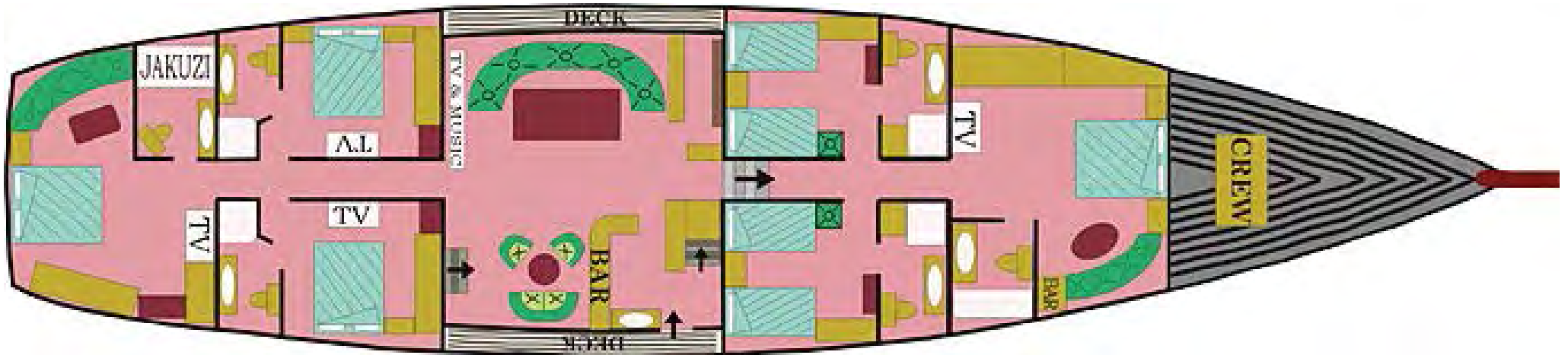



MOTOR SAILOR

# CANER IV

## SPECIFICATIONS

Type	: Motorsailor / Gulet
Flag / Registry	: Turkish Commercial
Base Port	: Bodrum
Length	: 36.0 m / 118'
Beam	: 8.1 m / 26'5"
Built / Refit	: 2008
Crew	: 6
Builder	: Bodrum Shipyard
Cruising Speed	: 11 Knots
Construction	: Wood
Masts & Rig	: 2 / Ketch
Engines	: Iveco 2 x 500 Hp
Electricity	: 220 V / 24 V
Generators	: Onan 2 x 27,5 kVa & 17,5 kVa

## ACCOMMODATION DETAILS

Cabins	: 2 Master Suites & 2 Double, 2 Twin
Bathrooms	: En-suite, Shower Cell
Air Conditioning	: Full
Salon	: Dining & Seating Area, Bar
Crew Quarters	: Separate
Galley	: Fully Equipped

 OCEAN YACHTING

### PER INFORMAZIONI

Ocean Yachting srl

Via Saragozza 24 40123 Bologna Italy

www.ocy.it | info@ocy.it | tel +39 0516440196



NUMBER OF CABINS

6

NUMBER OF GUEST

12

LENGTH OVER ALL

36.0 m

## ENTERTAINMENT & TOYS

VHF, GPS, dept sounder, radar, fishfinder, Plasma TV ( satellite cinema system), DVD, music system – iPod connection, CD-Player, refrigerator, deep-freeze, ice-maker. Dish washer, washing machine, drier. Full equipment for sailing, masks, flippers, 2x canoe, 1 x surf. Optional: Watersports 4.70 m 75 hp Mercury fast boat, ringo and waterski, wake-board and jetski.

## NAVIGATION & SAFETY

Radar, GPS, VHF, Chartplotter, Autopilot, Depth & Speed Indicators, Liferaft, Lifejackets, Fire Extinguishers, AIS

All specifications are given in good faith to the best of knowledge and offered for informational purposes only. The owner(s) and broker(s) do not warrant or assume any legal liability or responsibility for the accuracy, completeness, or usefulness of any information and/or images displayed. Yacht inventory, specifications and charter prices are subject to change without prior notice. None of the text and/or images used in this brochure maybe reproduced without written consent from the owner(s) and broker(s).