

## PROGRAMMA

### **Giorno 1 Mahe – St Anne Park**

Imbarco a Mahe entro pranzo. Spostamento al il Parco Marino di St. Anne, luogo meraviglioso per snorkeling. Ancoraggio per la notte

### **Giorno 2 Cocos Island – La Digue**

Visita e snorkeling presso il parco marino di St Anne. Dopo pranzo veleggiata verso Coco Island, caratterizzato da grandi rocce granitiche con strisce lavorate dalla natura. Bellissimi contratti di natura tra rocce, sabbia, mare e palme. Sott'acqua c'è un bellissimo snorkeling. Serata di fronte al villaggio di La Digue.

### **Giorno 3 La Digue**

Noleggio bicicletta per un tour di La Digue. Con i propri sentieri tra palme lussureggianti, piccole capanne per la produzione di copra, graniti dalle forma più bizzarre e spiagge bianchissime, La Digue è forse la più bella isola delle Seychelles. Notte a La Digue.

### **Giorno 4 Cousin – St Anne (Praslin)**

Spostamento all'oasi faunistica di Cousin. Nel pomeriggio Praslin. Possibilità di passeggiata nella Vallée de Mai, patrimonio mondiale dell'UNESCO, dove si può trovare il famoso Coco de mer.

### **Giorno 5 Grand Soer – Curieuse o Petit Cour (Praslin)**

Trasferimento a Grande Sœur. Barbecue sulla spiaggia, una delle più belle dell'arcipelago. Sport acquatici o una passeggiata di 40 minuti per scoprirla. Ancoraggio a Curieuse o Anse Petite Cour per la notte.

### **Giorno 6 St Pierre Islet – Anse Lazio o Anse Volbert**

Curieuse. L'isola fa parte del Parco Marino Nazionale. Qui stazionano più di cento tartarughe terrestri. Nel pomeriggio trasferimento a Saint Pierre Islet, dove spiaggia, rocce e palme si mescolano in uno scenario che è diventata l'immagine promozionale delle Seychelles.

Fantastico snorkeling. Ancoraggio per la notte in Anse Volbert o Anse Lazio, Praslin.

### **Giorno 7 Mahe**

Giornata dedicata al relax nelle spiagge di Praslin. Nel pomeriggio ritorno a Mahe.

### **Giorno 8 Sbarco**

Sbarco tra le 5.30 e le 8.30 di mattina.

**N.B.: L'ITINERARIO È PURAMENTE INDICATIVO E POTRÀ VARIARE A A INSINDACABILE GIUDIZIO DEL COMANDANTE PER MOTIVI DI SICUREZZA E METEO.**

## Crociere

La crociera è offerta in versione premium su catamarano Lagoon 620 o standard su catamarano Eleuthera 60 o Dream Catalante 60.

**Incluso nel prezzo:** Trattamento in pensione completa; 1 Cocktail al giorno; Sistemazione in cabina doppia con bagno privato e aria condizionata 08-22; Servizi d'equipaggio; 2 set di lenzuola, federe ed asciugamani da toilette e bagno; Maschere e pinne per snorkeling e kayak; gasolio.

**Escluso:** Escursioni; Volo aereo e tasse aeroportuali e di decollo; Destination fee €250/persona (include tasse di navigazione, e di ormeggio, tasse di parco, eventuale rabbocco d'acqua o gasolio, ripristino materiale rotto durante la crociera), Bevande, Trasferimenti A/R aeroporto imbarco. Possibilità di imbarco tardivo entro le h16.30 pagando un supplemento di €75/persona.

L'equipaggio pulisce le sole parti comuni. Possibilità di menu adattato per intolleranze/allergie, comunicato a 2 settimane dalla partenza (supplemento €120).

Imbarco posticipati entro le h18 con supplemento di €75

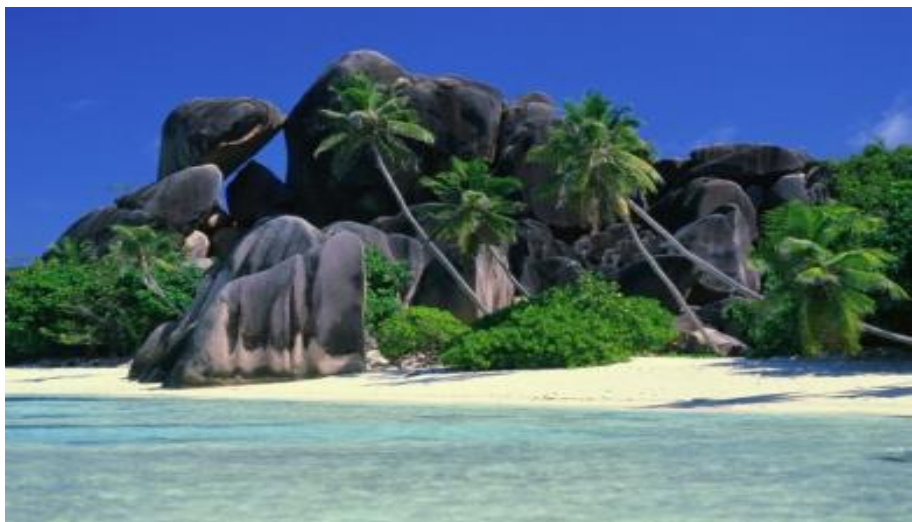

**Note:** Per i clienti che atterrano presto, nell'attesa dell'ora di imbarco, è disponibile il servizio di accesso alla piscina presso l'Hotel Eden Blue. Il costo è di 650 SCR. Possibile la colazione a pagamento.

Le bevande non incluse possono essere acquistate a bordo tramite l'uso dei token, in vendita a €4 l'uno. A fine crociera i token avanzati possono essere rimborsati o spesi presso lo shop della base.

L'equipaggio non pulisce le parti private ma solo le parti comuni.

Per le intolleranze (da comunicare entro 8 giorni dalla partenza sono disponibili i seguenti menu: vegano, vegetariano, pescato, celiaco, diabetico, senza pesce o frutti di mare, intollerante al lattosio.

Obbligatorio registrarsi al sito del visto online <https://seychelles.govtas.com/en>



## CATAMARANO UTILIZZATO NELLA CROCIERA PREMIUM

Catamarano **Lagoon 620** di 19 metri, 6 cabine 6 wc + alloggi per le 2 persone d'equipaggio. Le due cabine di prua e poppa sono Superior soggette a supplemento

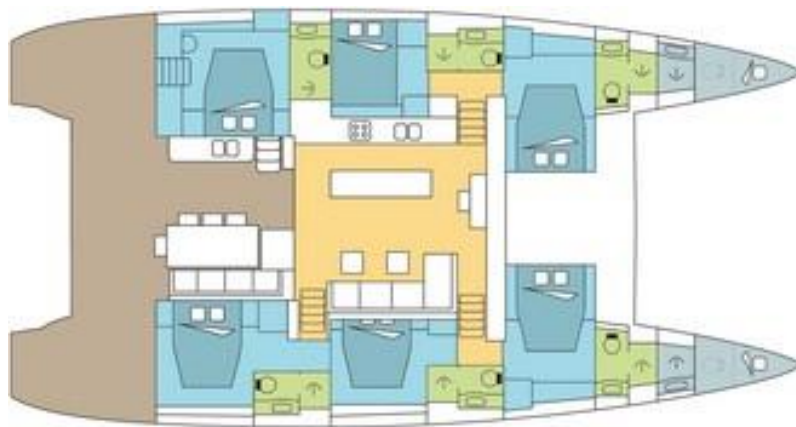

## CATAMARANO UTILIZZATO NELLA CROCIERA STANDARD

Catamarano **Catalante Dream 60** di 19 metri, 6 cabine (di cui 2 con terzo letto, di dimensioni ridotte) e alloggi equipaggio. Ampio flybridge.

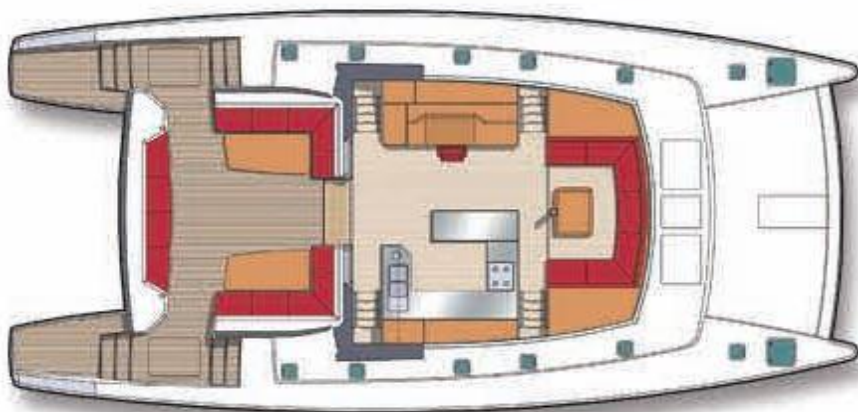

**CATAMARANO UTILIZZATO NELLA CROCIERA STANDARD** Catamarano **Eleuthera 60** di 19 metri, 4+1 cabine 4+1 wc + alloggi equipaggio e 2 persone d'equipaggio.

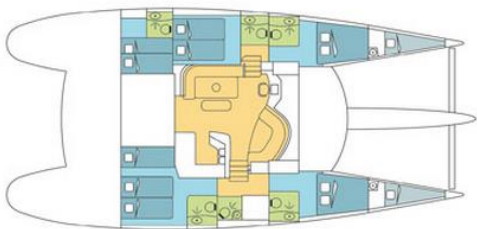

Praslin Dream Premium cruise				
8 days / 7 nights, Mahé - Mahé on board our catamaran Lagoon 620				
Dates		Price in € per person per cruise in full board		
Departure	Return	Double		Single
Passports details must imperatively be communicated to the base at least 2 weeks before clients arrival				
05/01/2026	12/01/2026	1.970		N/A - see note*1
12/01/2026	19/01/2026	1.970		N/A - see note*1
19/01/2026	26/01/2026	1.970		N/A - see note*1
26/01/2026	02/02/2026	1.970		N/A - see note*1
02/02/2026	09/02/2026	2.185		N/A - see note*1
09/02/2026	16/02/2026	2.335		N/A - see note*1
16/02/2026	23/02/2026	2.335		N/A - see note*1
23/02/2026	02/03/2026	2.335		N/A - see note*1
02/03/2026	09/03/2026	2.335		N/A - see note*1
09/03/2026	16/03/2026	2.335		N/A - see note*1
16/03/2026	23/03/2026	2.425		N/A - see note*1
23/03/2026	30/03/2026	2.490		N/A - see note*1
30/03/2026	06/04/2026	2.490		N/A - see note*1
06/04/2026	13/04/2026	2.490		N/A - see note*1
13/04/2026	20/04/2026	2.490		N/A - see note*1
20/04/2026	27/04/2026	2.490		N/A - see note*1
27/04/2026	04/05/2026	2.370		N/A - see note*1
04/05/2026	11/05/2026	2.235		N/A - see note*1
11/05/2026	18/05/2026	2.105		N/A - see note*1
18/05/2026	25/05/2026	1.975		N/A - see note*1
25/05/2026	01/06/2026	1.890		N/A - see note*1
01/06/2026	08/06/2026	1.830		N/A - see note*1
08/06/2026	15/06/2026	1.760		N/A - see note*1
15/06/2026	22/06/2026	1.760		N/A - see note*1
22/06/2026	29/06/2026	1.760		N/A - see note*1
29/06/2026	06/07/2026	1.850		N/A - see note*1
06/07/2026	13/07/2026	1.940		N/A - see note*1
13/07/2026	20/07/2026	2.030		N/A - see note*1
20/07/2026	27/07/2026	2.030		N/A - see note*1
27/07/2026	03/08/2026	2.030		N/A - see note*1
03/08/2026	10/08/2026	2.030		N/A - see note*1
10/08/2026	17/08/2026	2.030		N/A - see note*1
17/08/2026	24/08/2026	1.965		N/A - see note*1
24/08/2026	31/08/2026	1.895		N/A - see note*1
31/08/2026	07/09/2026	1.895		N/A - see note*1
07/09/2026	14/09/2026	1.895		N/A - see note*1
14/09/2026	21/09/2026	1.970		N/A - see note*1
21/09/2026	28/09/2026	2.055		N/A - see note*1
28/09/2026	05/10/2026	2.295		N/A - see note*1
05/10/2026	12/10/2026	2.495		N/A - see note*1
12/10/2026	19/10/2026	2.620		N/A - see note*1
19/10/2026	26/10/2026	2.620		N/A - see note*1
26/10/2026	02/11/2026	2.620		N/A - see note*1
02/11/2026	09/11/2026	2.620		N/A - see note*1
09/11/2026	16/11/2026	2.620		N/A - see note*1
16/11/2026	23/11/2026	2.620		N/A - see note*1
23/11/2026	30/11/2026	2.495		N/A - see note*1
30/11/2026	07/12/2026	2.140		N/A - see note*1
07/12/2026	14/12/2026	1.970		N/A - see note*1
14/12/2026	21/12/2026	1.970		N/A - see note*1
26/12/2026	02/01/2027	2.765		N/A - see note*1

\*Solo special pricing is applied to specific departures 2 months or less before departure - please contact your sales agent

Extra charge for the superior cabin : 190 EUR per cabin (rear or front cabin, non commissionable)

Embarkation: Mahé, Eden Island - Monday, at 13.00 (1 pm)

(late embarkation possible until 6 pm with extra fee of 75 Euros per person to be added to the one way transfer cost)

Disembarkation: Mahé, Eden Island - Monday, between 5.30 and 8.30 am

Prices may be reviewed every 3 to 6 months.

Minimum Age: 6 years old

It belongs to travellers to check that they meet visa requirements for the visited country

Any change of name / date will be charged: 30 € per file and per change

All travellers are required to complete Immigration procedures prior travelling to and from Seychelles.

[Please check Seychelles government website](#)

The entry form needs to be filled 3 days prior the departure.

#### RATES INCLUDE

- Accommodation in air-conditioned double cabin with private bathroom (A/C in service from 8.00 am to 10.00 pm)
- Full board (breakfast, lunch, diner)
- 1 local cocktail every evening per guest (made from rum, prosecco, etc...depending on destination // not personalized), drinks (table wine, 1/2L /guest /day) during meals, fruit juices, sodas
- Possibility to order tokens (1 token = 4 €) to exchange on board against additional alcohol (list available on Excel file)
- Service of the crew : 2 persons (captain, steward/cook)
- 2 sets of linen, towels and beach towels /pax /cruise (3 sets for the 10 nights cruises)
- Consumables for the yacht (diesel, fuel and water)
- Insurance for the yacht and the passengers
- P&I insurance for the passengers to cover DYW civil responsibilities (valid for all cabin catamarans of 54' and more)
- Water sports on board : snorkelling equipment, 2 paddles & 1 kayak tandem (in case of availability issue the kayak tandem may be replaced by a single kayak)

Crew is in charge of cleaning common parts only

Passengers are not allowed to bring their own beverages onboard

#### RATES DO NOT INCLUDE

- Airfares
- The Tourism Environmental Sustainability Levy: Compulsory to pay in SCR or equivalent Currency as per daily rate on base. To be paid locally, price is 100 SCR per person per day. NOT be applicable to citizens and residents of Seychelles, children of 12 years and below (visitors), and Dream Yacht crew.
- Beverages, other than mentioned above
- Transfers airport – base – airport (optional)
- Destination fee (mandatory): To be paid in advance
- Personal travel insurance
- Alcoholic drinks apart of any mentioned above in included
- Extra for special diets: details below
- Wifi (25GB / day): 30€ per cabin
- Charge for late passport info: 150 € per cabin, payable at the base

(charged if not received within 1 wk - last minute bookings excepted - to ensure cabin cruise start is not delayed)

#### SPECIAL DIETS

We strive to offer best service possible at Dream Yacht Worldwide, and special diets add a level of complexity for our cooks to prepare great meals for up to 12 guests in well-designed & functional kitchens, but still with limited space on board. There is also the challenge to find the right products in remote destinations where we operate and substitutions often incur an additional expense. After a full review of our operations, to ensure all guests on board receive the same level of service independently of having or not food restrictions, we decided to charge this moderate extra for special diets

As usual, we do not take care of food preferences on cabin charters.

We can cater for 8 different types of diets:

1. Vegan diet
2. Vegetarian diet
3. Pescatarian diet
4. Gluten-free diet
5. Diabetic diet
6. No fish / No seafood diet
7. Dairy free diet
8. Lactose free diet

The amount of extra for special diets is 120€ per person, payable in advance

#### TRANSFERS DETAILS (optional)

• Transfers Mahe airport – base – airport

1 to 3 persons	€ 78
4 to 6 persons	€ 117
7 to 12 persons	€ 195

• Transfer one way: 50% of the round trip price

#### DESTINATION FEE DETAILS (mandatory)

(destination fee includes, depending on the destinations)

- National park fees (for the boat)
- Tourist taxes and landing fees on the islands
- Mooring fees
- Possible re-fills of water, fuel, gas, fresh products
- Miscellaneous: repurchase of broken crockery, lost of snorkeling equipment, sea kayaks..

The amount of Praslin Dream destination fee is 250 Euros per person, payable in advance

#### POOL VOUCHER (Optional)

We have a new offer for our clients arriving early in Mahe on their first day or leaving late on their last day. It's now possible for our clients to spend 4 hours at the pool area of the Eden Bleu hotel, next door to our office before embarking meeting at 1pm. This service is exclusive to Dream Yacht Worldwide clients to allow a serene start for their holidays. Clients will be first greeted at our Eden office (opened from 7.30am on check-in days) for admin matters & Seychelles tax payment.

POOL VOUCHER information + (optional) Breakfast:

- Pool Voucher Cost is 650 SCR per adult & 325 SCR per child
- A reservation is required for all guests before getting to the hotel. Reservations are made strictly by DYW Seychelles base in Mahe.
- Payment of the Pool Voucher is made directly by the clients at Eden Hotel Reception, where the Pool Vouchers are also handed to our clients.
- Pool Voucher INCLUDES: Pool usage between 09h00 and 15h00, 1 pool towel, 1 soft drink OR 1 draft beer (small) OR 1 bottle of water, 1 tea or coffee, luggage storage
- Pool Access Vouchers are valid strictly from 9am-3pm (after 3pm the Pool is reserved for hotel in-house guests only).
- The price of the voucher is non-negotiable irrespective of hours spent at the hotel
- Breakfast buffet is available in the morning at an additional fee of 605 SCR per person (ADULTS) and for the Kids, 5-12yrs is 357.50 SCR per person (for kids 0-4 accompanying a parent breakfast is free of charge) payable on site.
- A maximum of 20 Pool access vouchers can be sold per day; the hotel reserves the right to reduce the quantity depending on the availability of Swimming Pool